

REPLACEMENT PARTS LIST
WARN XDR9001 WINCH

WARNING INFORMATION:
Always use proper tie-off technique. Do not use a single wrap. Always use proper tie-off technique. Do not use a single wrap. Always use proper tie-off technique. Do not use a single wrap.

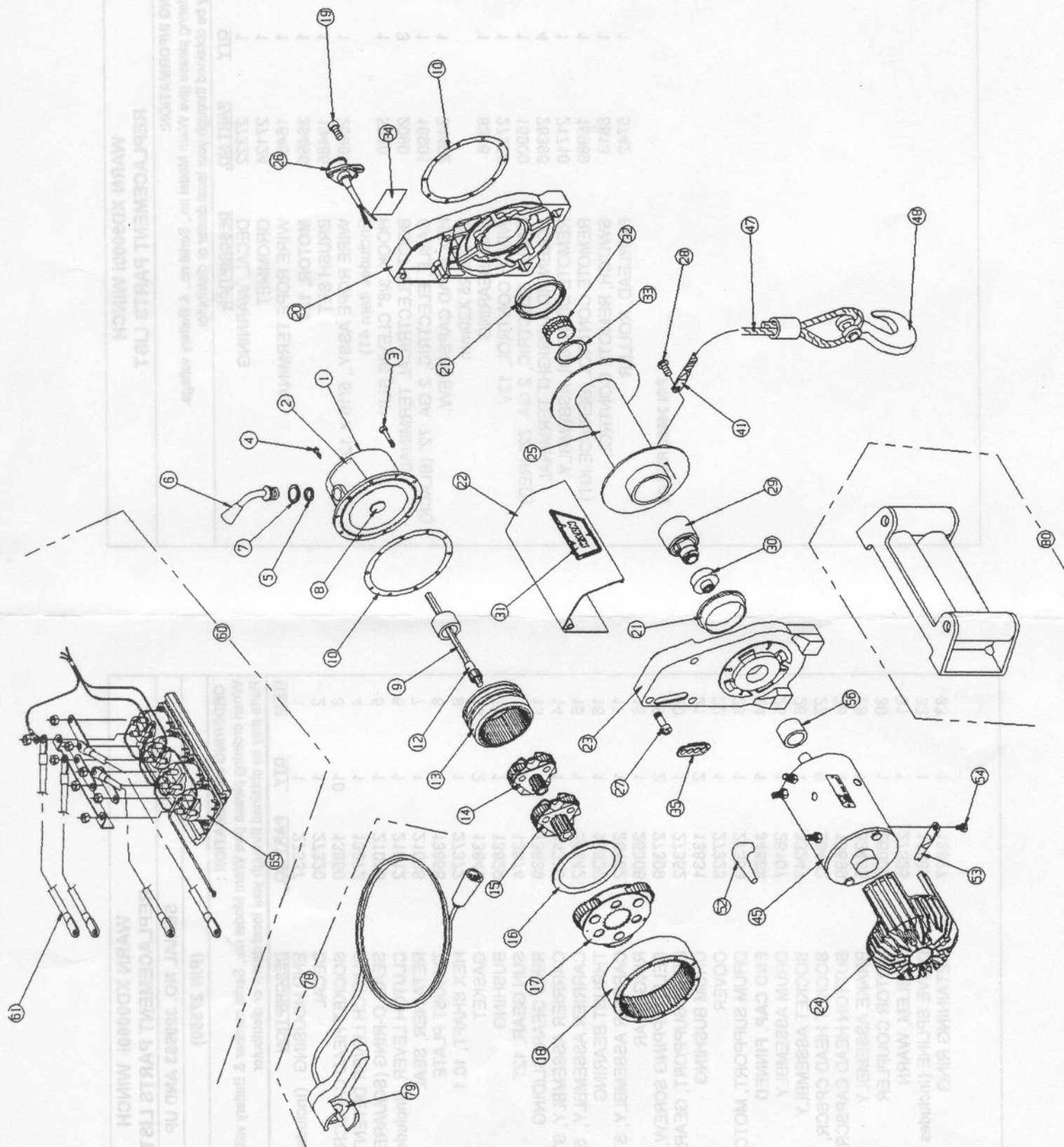

**WARN XD9000i WINCH
REPLACEMENT PARTS LIST**

ORDERING INFORMATION:

When ordering please give Warn Model no., Serial no., & Battery voltage.
Parts may be obtained through your local dealer or distributor.

<u>ITEM</u>	<u>QTY</u>	<u>PART NO.</u>	<u>DESCRIPTION</u>
34	1	27322	DECAL, WARNING
35	1	27124	GROMMET
41	1	16463	WIRE ROPE TERMINAL
45	1	36466	MOTOR, 12V
	1	19485	BRUSH SET
47	1	25987	WIRE ROPE ASSY., 5/16 X 125' (Includes item 41)
48	1	5320	HOOK, 3/8" CLEVIS SLIP
52	3	2090	BOOT, ELECTRICAL TERMINAL
53	1	15901	CABLE, ELECTRIC, 2 GA. 72" (BLACK)
54	1	34402	HEX HEAD CAPSCREW, M8 X 2.25 X20mm
56	1	8316	BALL BEARING
60	1	27326	WINCH CONTROL, 12V
61	1	15900	CABLE, ELECTRIC, 2 GA. 72" (RED)
65	4	28396	SOLENOID, UPRIGHT TERMINAL
78	1	21710	REMOTE CONTROL ASSEMBLY
	1	15989	REMOTE CONTROL (SERVICE KIT)
79	1	8813	SWITCH, REMOTE CONTROL
80	1	5742	FAIRLEAD, ROLLER

P/N 34590 REV A0

**WARN XD9000i WINCH
REPLACEMENT PARTS LIST**

SERIAL NO. 399963 AND UP

(P/N 27550)

ORDERING INFORMATION :

When ordering please give Warn Model no., Serial number & Battery voltage.
Parts may be obtained through your local dealer or distributor.

<u>ITEM</u>	<u>QTY</u>	<u>PART NO.</u>	<u>DESCRIPTION</u>
1	1	27337	END HOUSING (Includes items 2, 8&11)
2	1	27320	DECAL
3	10	13850	SOCKET HEAD CAPSCREW, 10-24X2 1/2
4	1	13872	CLUTCH LEVER DETENT SCREW
5	1	21010	SEAL, O-RING (SQUARE)
6	1	21012	CLUTCH LEVER, (Includes items 4,5&7)
7	1	21008	RETAINER, SEAL
8	1	13868	THRUST PLATE
9	1	27372	HEX SHAFT, 10.1
10	2	13848	GASKET
11	1	13829	BUSHING
12	1	13874	SUN GEAR, 12T
13	1	13839	RING GEAR, SLIDING
14	1	34339	CARRIER ASSEMBLY, STAGE 1
15	1	34342	CARRIER ASSEMBLY, STAGE 2
16	1	13826	THRUST BEARING
17	1	28432	CARRIER ASSEMBLY, STAGE 3
18	1	25308	RING GEAR
19	2	27309	SELF TAPPING SCREW, 10-24X3/4"
20	1	27352	DRUM SUPPORT, GEAR TRAIN
21	2	13831	DRUM BUSHING
22	1	27323	COVER
23	1	27353	DRUM SUPPORT, MOTOR, (Includes item 56)
24	1	34588	END CAP, FINNED
25	1	26107	DRUM ASSEMBLY
26	1	33247	SOCKET ASSEMBLY
27	6	28462	SOCKET HEAD CPSCR, 5/16 X 1-1/2"
28	1	13699	BUTTON HEAD CAPSCREW, 1/4-20X1/4"
29	1	32455	BRAKE ASSEMBLY
30	1	26006	MOTOR COUPLER
31	1	27325	EMBLEM, WARN
32	1	14584	DRIVE SPLINE (Includes item 33)
33	1	13827	RETAINING RING